

ROAD NAME INDEX

ROAD NAME	MAP NO.	ROAD NAME	MAP NO.	ROAD NAME	MAP NO.
ALBERTA CT.	SE-10	GRANTHAM RD.	SE-18	RUBY RD.	SE-19
DALL CT.	SE-13	GREENWOOD CT.	SE-12	GREENWOOD CT.	SE-8
BALDOCK RD.	SE-13	GRIEVE RD.	SE-12	SALLOWES RD.	SE-19
BEDFORD LANE	SE-18	GULLEY RD.	SE-11, SE-12, SE-16	SAUCIER RD.	SE-12, SE-18, SE-19, SE-21, SE-22
BEDFORD RD.	SE-18, SE-21	HALL RD.	SE-8, SE-15	SEALY RD.	SE-13
BEMLAY RD.	SE-10	HART RD.	SE-11, SE-12	SEEDON RD.	SE-8
BEMROSE RD.	SE-5, SE-6	HARVARD RD.	SE-14, SE-19	SENGER RD.	SE-6
BERARD RD.	SE-16	HAYES RD.	SE-13, SE-14	SPAARPAK RD.	SE-7
BORLAND RD.	SE-5, SE-6	HEMLICH RD.	SE-16	SPERS RD.	SE-12, SE-16, SE-17
CARTER RD.	SE-7	HEWLETT RD.	SE-12	STEWART RD. E.	SE-19
CASORSO RD.	SE-17, SE-20	HUGHES RD.	SE-20, 21	STEWART RD. W.	SE-19, SE-21
CLAXTON CT.	SE-7	HYAK RD.	SE-7	SUMMERSIDE DR./CT.	SE-7
COMO RD.	SE-22	JACKSON CT.	SE-15	SUNCREST CT.	SE-7
CORONADO CT.	SE-19, SE-21, SE-22	JAMES RD.	SE-15	SUNSHINE RD.	SE-7
CRAWFORD RD.	SE-10	JEAN RD.	SE-7, SE-8	SWAMP RD.	SE-20, SE-21
DALL RD.	SE-10	JOHNSON RD.	SE-9	TAKLA RD.	SE-18
DEHART RD.	SE-21	JUNE SPRINGS RD.	SE-7, SE-8, SE-12	TATLOW RD.	SE-7
DELPERNH CT.	SE-8	KEKULI CT.	SE-7	TILGUM CT.	SE-7
DIAMOND RD.	SE-19	KIMATOUCHE RD.	SE-7	TODD RD.	SE-17, SE-18
DUNSMUIR RD.	SE-10, SE-15	KLO RD.	SE-10, SE-15	TURTON CT.	SE-17
DUNSTER RD.	SE-9, SE-10	LAKEVALE PL.	SE-7	WALLACE HILL RD.	SE-12, SE-13, SE-18, SE-19
EAST KELOWNA RD.	SE-5, SE-10	LAKEVALE CT.	SE-7	WARD RD.	SE-17
EASTWOOD DR./CT.	SE-7	LANCASTER CT.	SE-19	WATER RD.	SE-7, SE-12
FARRALL RD.	SE-15	LEMKY RD.	SE-7	WILDWOOD RD.	SE-15
FAIRWINDS CT.	SE-7	LUPIN CRES.	SE-12	WISTERIA CT.	SE-7
FEENY RD.	SE-6, SE-7	LUXMOORE RD.	SE-8	WOODLAND CR.	SE-9
FIELD RD.	SE-6, SE-7	MAHONIA DR.	SE-7		
FITZGERALD RD.	SE-4, SE-6	MAHONIA DR. S.	SE-8		
FLOWER CT.	SE-7	MAQUINNA RD.	SE-15		
GALLAGHERS BLVD. S.	SE-4	MAQUINNA PL.	SE-9		
GALLAGHERS CANYON BLVD.	SE-4	MAQUINNA RD.	SE-15		
GALLAGHERS CIRCLE	SE-4, SE-7	MATHEWS RD.	SE-8, SE-13		
GALLAGHERS CRES.	SE-7	McCLAIN RD.	SE-2, SE-4, SE-7, SE-10, SE-11, SE-12		
GALLAGHERS CROSSWAY	SE-7	McCULLOCH RD.	SE-8		
GALLAGHERS DR. E.	SE-4	MILLER RD.	SE-21		
GALLAGHERS DR. W.	SE-4	MISSION RIDGE DR./CT.	SE-7		
GALLAGHERS EDGEWOOD DR./CT./PL.	SE-4	MOWITCH CT.	SE-10		
GALLAGHERS FAIRWAY S.	SE-4, SE-7	NEID RD.	SE-10		
GALLAGHERS FOREST SOUTH.	SE-4	OREILLY LANE	SE-10		
GALLAGHERS GRANGE	SE-4	OREILLY RD./CT.	SE-10, SE-15		
GALLAGHERS GREEN	SE-4	PACKERS RD./CT.	SE-10, SE-15		
GALLAGHERS GROW.	SE-7	POOLEY RD.	SE-5, SE-10		
GALLAGHERS PARKLAND DR.	SE-4	POWELL RD.	SE-9		
GALLAGHERS PARKWAY	SE-4	PROSPECT RD.	SE-13		
GALLAGHERS PINNACLE WAY	SE-4	REEKIE RD.	SE-6, SE-11		
GALLAGHERS TERRACE	SE-4, SE-7, SE-8	REGINA RD.	SE-13		
GARDENIA CT.	SE-7	REID RD.	SE-5		
GASPARDONE	SE-14	ROBINIA CT.	SE-7		
GLENN CT.	SE-8	ROMA CT.	SE-22		
GOODISON CT.	SE-8	ROSE RD.	SE-10, SE-11		

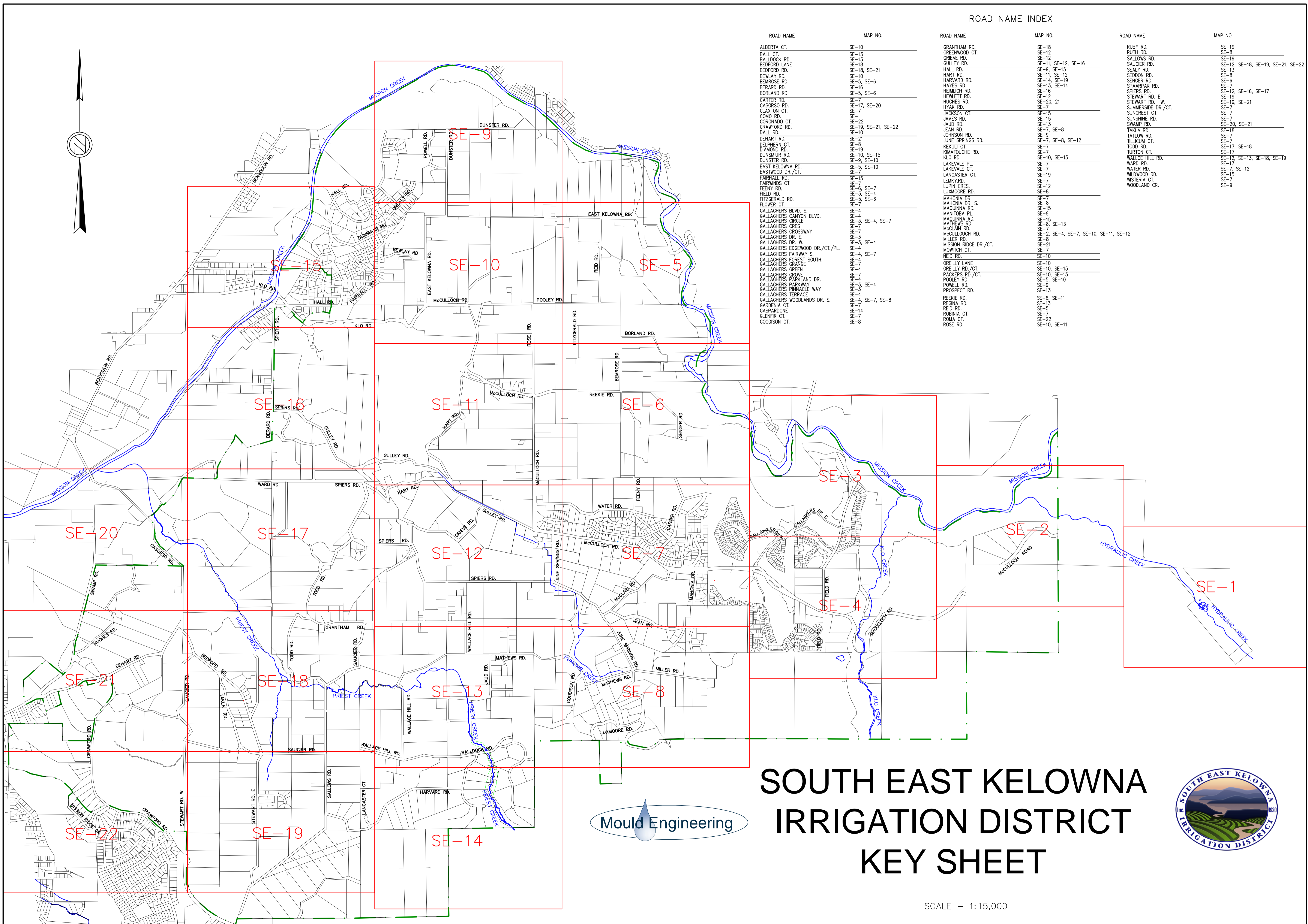

SOUTH EAST KELOWNA IRRIGATION DISTRICT KEY SHEET



SCALE - 1:15,000